

Stefan Darlan Boris, Cand.arch., PhD

& Mo Michelsen Stochholm Krag, Cand.arch., PhD

Aarhus School of Architecture, Denmark

E-mail: Stefan: sdb@aarch.dk, Mo: mok@aarch.dk



BEDSTED STATIONS- OG SKOVBY

Agenda:

-introduktion

-historik

-The controlled ruin
start marts 2014

-Bedsted Stationsby
start december 2019



AARHUS LANDSKABSLABORATORIUM

Transformationer i Aarhus Ådal

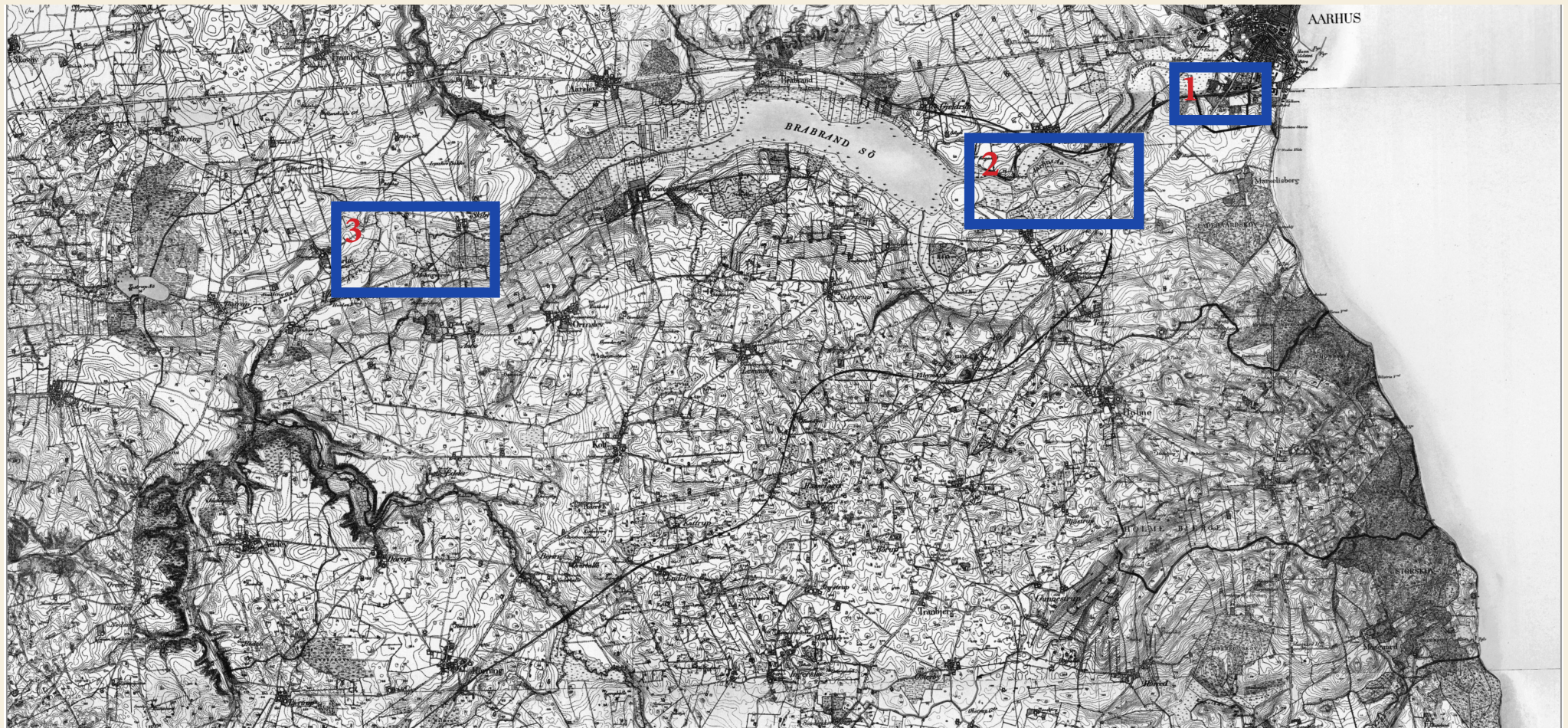

3 Dyrkningslandskab

2 Overgangslandskab

1 Bymidte (jernbane)

BEDSTED SKOVBY

Transformationer i Thy



3 Dyrkningslandskab

2 Overgangslandskab

1 Bymidte (jernbane)

BEDSTED SKOVBY

Transformationer i Thy



3: Rønhede Plantage (2020)

Samarbejde (AAA+TK)

Statsskov (1900) og ny skov (2020)

Forsøg i 1:1

Mulighed for opskalering



2: Thylandsgade (2019)

Samarbejde (AAA+TK)

Kommunalt opkøb (fra 2019)

Forsøg i 1:1

Mulighed for opskalering



1: Stationspladsen (2021)

Samarbejde (AAA+TK)

Kommunalt + DSB (stationsbygning)

Forsøg i 1:1

Mulighed for opskalering

AARHUS LANDSKABSLABORATORIUM

Transformationer i Aarhus Ådal



3: Åbo Skov (2021)

Tværfagligt (AAU+AAA+AAK)

Kommunal skov (2014)

Forsøg i 1:1.

Mulighed for opskalering



2: Eskelunden (2016)

Tværfagligt (AAU+AAA+AAK+NM)

Kommunal eventplads (2020)

Forsøg i 1:1

Mulighed for opskalering

Sallingfonden, Grønne Projekter



1: Ny Arkitektskole (2020)

Tværfagligt (AAU+AAA+AAK)

BYGST (2020)

Forsøg i 1:1

Mulighed for opskalering

AARHUS LANDSKABSLABORATORIUM

1: Ny Arkitektskole (2020)

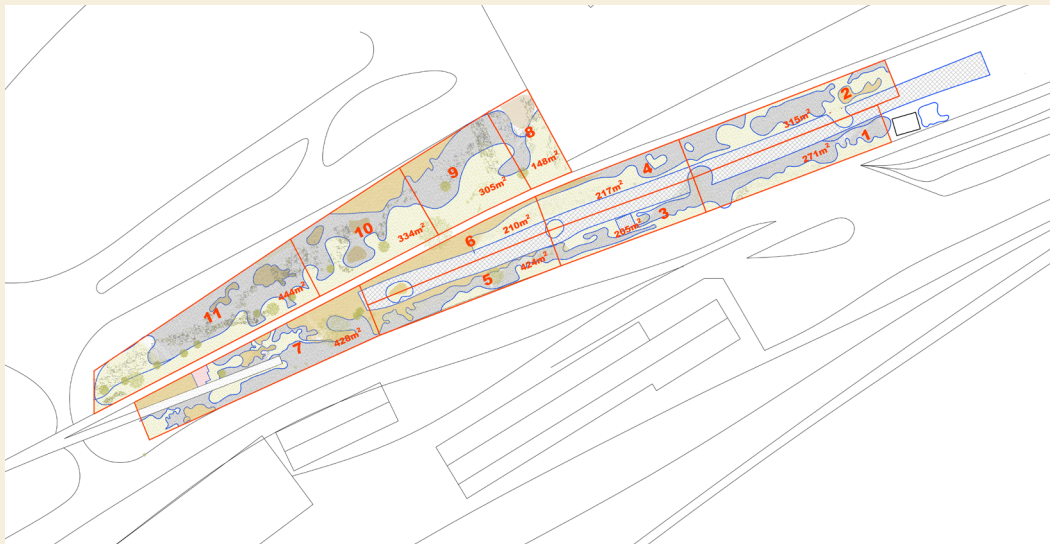

Donorplots (3300m2)



Godsbanen, Rethink Urban Habitats 2017

AARHUS LANDSKABSLABORATORIUM

1: Ny Arkitektskole (2020)



AARHUS LANDSKABSLABORATORIUM

2: Eskelunden (2016)

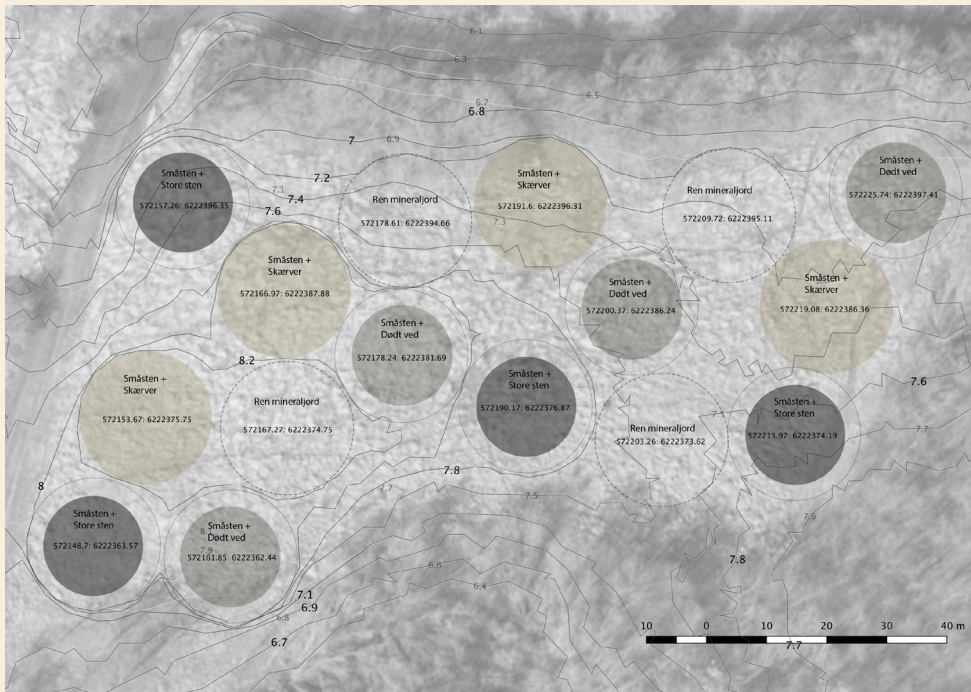

Godsbanepodning (2017)



Richard Long, Hoggar Circle (1988)

AARHUS LANDSKABSLABORATORIUM

2: Eskelunden (2016)



Godsbanepodning nr. 7 - store skærver (juni, september, december 2017)

AARHUS LANDSKABSLABORATORIUM

3: Åbo Skov (2021)

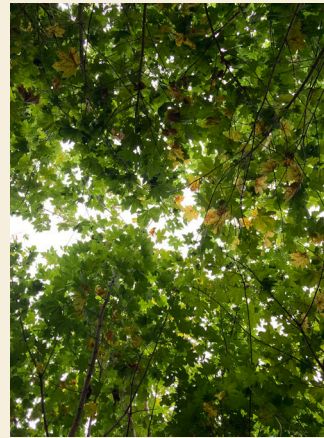

Studio 1A UD|LA (2021) - forløb, rum (lysninger), kanter (bryn)

BEDSTED STATIONS- OG SKOVBY

Agenda:

-introduktion

-historik

-The controlled ruin
start marts 2014

-Bedsted Stationsby
start december 2019









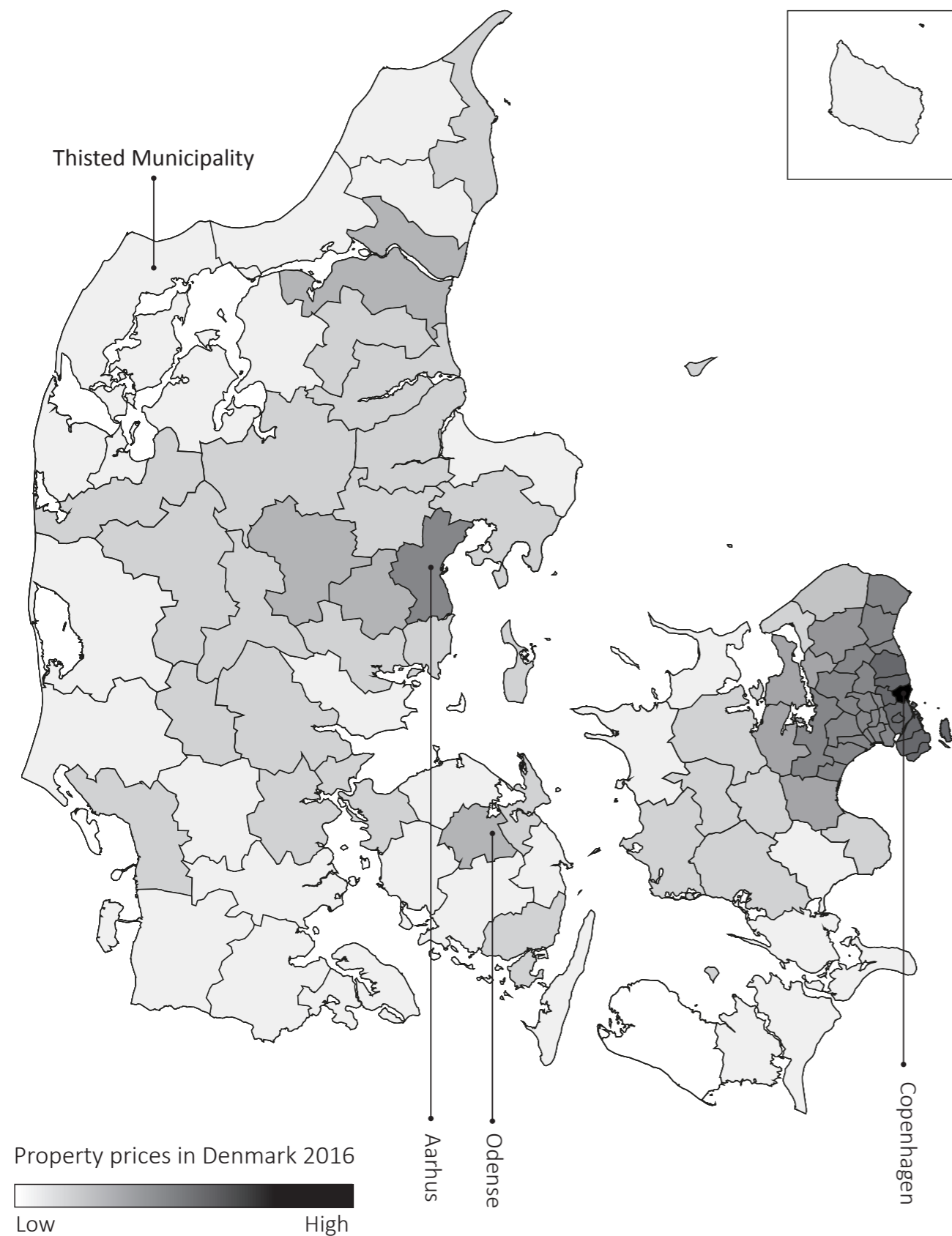

(Danish Statistics, 2016).

Aspects of cultural heritage:

How does Denmark cope with our cultural heritage in regard to both definitions and strategies of preservation? Does preservation of the built environment have to build on what appears as delicate material reconstruction, or could more radical methods be enabled to reveal what is beneath the surface? Furthermore, how do we select buildings for preservations in a more nuanced way to avoid a rapid eradication of the recent history of rural everyday life?

Structure and density in the rural village:

To what extent does the offset of the individual building go beyond its physical boundaries, and how does it impact on the rural village as whole, when several buildings are demolished from one day to another?

Narratives of place:

Could buildings be preserved, within contested rural village communities, as a strengthened collective memory in the form of exchanged narratives of buildings? What is the minimum need to link the narratives to a certain place?







Made by first year students and educators in 2013



Made by first year students in 2011